

FILTER MODULE

F251X1-XXX

RELEASED: 1-21-00
REVISED:
(REV.)

TECHNICAL SPECIFICATIONS

MATERIALS OF CONSTRUCTION

Body: Glass reinforced nylon.

Bowls: Polycarbonate or glass reinforced nylon.

Bowl Guard: Glass reinforced nylon.

Seals: Nitrile.

Drain: Tire valve type.

Filter Element: Porous polypropylene.

OPERATION CONDITIONS

Temperature Range: 0° to 125° F (-18° to 52°C).

Max. Inlet Air Pressure: Poly bowl - 200 p.s.i.g. (13.8 bar)

Nylon bowl - 150 p.s.i.g. (10.3 bar)

Application: Industrial compressed air systems.

Sump Capacity (Filters): 0.60 oz. (17.7 ml).

Filter Area (Filters): 3.02 in.² (1949 mm²).

Flow: Air flow is at 90 p.s.i.g. (6.2 bar) inlet and 5 p.s.i.g. (0.3 bar) pressure drop.

1/8" - 28 scfm (13 dm³/s)

1/4" - 38 scfm (18 dm³/s)

PARTS LIST

ITEM	DESCRIPTION (SIZE) [INCLUDES]	QTY	PART NO.
F1	Filter Base	(1)	N / A
F2	Element Holder (torque to 5 - 9 in. lbs)	(1)	29562
✓ F3	"O" Ring (1/16" x 1-7/16" o.d.)	(1)	Y325-27
F4	Plate	(1)	29585
F5	Filter Element, Coalescing (.3 micron)	(1)	29586
F6	Spinner	(1)	29560
F7	Filter Element (5 micron)	(1)	29660-1
	Filter Element (20 micron)	(1)	29660-2
F8	Pulse Drain Kit [F9]	(1)	104264
✓ F9	"O" Ring (1/16" x 1/4" o.d.)	(1)	Y325-6
F10	Valve Core	(1)	29165
F11	Poly Bowl / Guard Assy with Drain [F3 and F10]	(1)	104258
F12	Nylon Bowl with Drain [F3 and F10]	(1)	104259
✓	Items included in Filter Repair Kit	(1)	104257

Key-Lube® is a registered trademark of Key Industries.

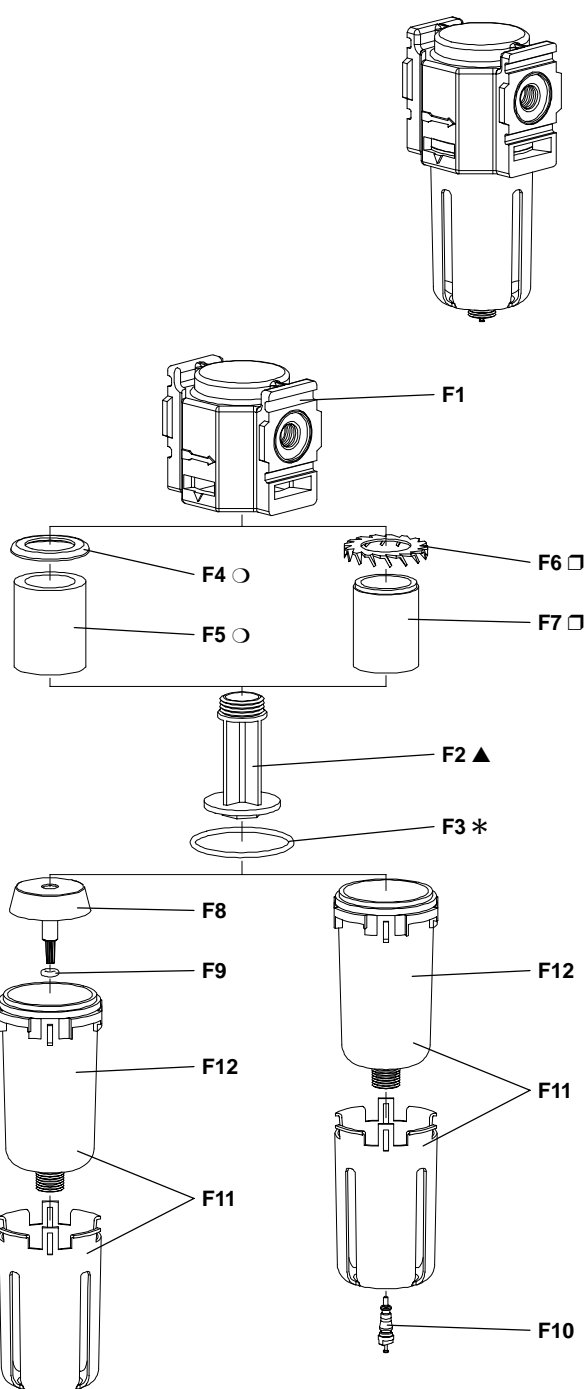

▲ Torque to 5 - 9 in. lbs (.56 - 1.02 Nm.)

* Lubricate with Key-Lube® upon assembly.

□ Used on models F251X1-2XX and F251X1-4XX.

○ Used on models F251X1-3XX.

ARO

INGERSOLL-RAND COMPANY
P.O. BOX 151 • ONE ARO CENTER • BRYAN, OHIO 43506-0151

☎ (419) 636-4242 • FAX (419) 633-1674

© 2000 • PRINTED IN U.S.A.

INGERSOLL-RAND
FLUID PRODUCTS

OPERATING AND SAFETY PRECAUTIONS

- Use only genuine ARO replacement parts to assure compatible pressure rating and performance.
- Read carefully all warnings and safety precautions and heed the following before operating, to avoid personal injury and / or property damage.
- Be certain anyone operating this equipment has been trained to use it safely.

⚠ WARNING COMPONENT RUPTURE. DO NOT EXCEED MAXIMUM RATED OPERATING PRESSURE OF: Polycarbonate Bowl - 200 p.s.i. (13.8 bar), Glass filled Nylon Bowl - 150 p.s.i. (10.3 bar). To avoid possible damage or personal injury, DO NOT expose the unit to excessive pressure beyond the intended working range.

⚠ WARNING TEMPERATURE LIMITS. DO NOT EXCEED MAXIMUM TEMPERATURE LIMITS OF 125° F (52° C). Excessive temperature can affect non-metallic parts which may weaken them and cause failure.

⚠ WARNING USE WITH INDUSTRIAL COMPRESSED AIR SYSTEMS ONLY. DO NOT USE WITH BOTTLED GAS PRODUCTS OR FLUIDS. MISAPPLICATIONS CAN RESULT IN COMPONENT FAILURE.

⚠ WARNING DISASSEMBLY HAZARD. DO NOT DISASSEMBLE THIS UNIT WHEN IT IS UNDER PRESSURE. SHUT OFF AND RELIEVE AIR SUPPLY BEFORE ATTEMPTING SERVICE OR DISASSEMBLY PROCEDURES.

Isolate the unit by closing the line valve or disconnect the supply line or hose.

⚠ WARNING BOWL REMOVAL HAZARD. THE BOWL MUST BE SECURELY LOCKED INTO POSITION BEFORE EXPOSING THE UNIT TO LINE PRESSURE. The bowls are designed with a feature which inhibits removal while under pressure. When reinstalling, push the bowl up into the body and rotate to the right 1/8 turn. Failure to lock the bowl could cause it to blow off, which could result in personal injury or property damage.

⚠ WARNING DO NOT USE DEGREASERS OR SOLVENTS TO CLEAN POLYCARBONATE BOWLS. Exposure internally or externally to incompatible chemicals or their vapors or fumes could attack and weaken polycarbonate material, causing failure. DO NOT EXPOSE to acetone, trichloroethane, gasoline, alcohols, ketones, esters, chlorinated hydrocarbons, toluene, etc. Clean polycarbonate bowls with soap and water or kerosene only. USE COMPATIBLE LUBRICATING OILS ONLY. Lubricating oils used in plastic bowls must be compatible with polycarbonate plastic (some "fire resistant" oil additives are not compatible). Fumes of these substances in contact with polycarbonate bowls internally or externally can also damage the bowl. Consult the chemical / oil manufacturer for compatibility and temperature limits. Refer to "Technical Specifications" on page 1 of this manual.

INSTALLATION

- Install filter with the air flow as indicated by the arrow on the unit.
- Install filter as close as possible to the air operated equipment for best performance.
- Filter must be installed with the bowl downward for proper operation.
- Locate the filter upstream from the regulator and lubricator.

OPERATION

- Monitor the sediment accumulation.
- If the pressure drop across the filter becomes excessive, empty the filter bowl, clean or replace the filter element to assure good performance.
- Clean the filter element periodically. Soak the filter bowl and clean with soap and water. Refer to warnings concerning polycarbonate bowls.

MAINTENANCE

- Filters with manual drain must be drained as frequently as necessary to keep the liquid level below the baffle, which could cause liquid to be carried downstream.